

OWNER'S MANUAL

MODEL TC-5000

Please read carefully before using this equipment

Treasure Cove Gold Rush Metal Detector

With your new Gold Rush TC-5000 metal detector, you can easily hunt for coins, relics, jewelry, gold and silver just about anywhere. Your TC-5000 allows you to search in almost any location, including lawns, fields, snow-filled areas, mountain trails and beaches. The TC-5000 metal detector is versatile and easy to use.

Your TC-5000 has three operating modes:

DISCRIMINATION- This mode can facilitate searching for and discriminating the target type.

ALL METAL- This mode is used to search for all kinds of metal objects.

TARGET- This mode is used to pinpoint the target accurately by lowering the sensitivity level.

- **LED Indicator-** When the target is found, the green LED lights will activate. The red LED lights indicate the battery is low.
- **Headphone Jack-** This allows for you connect any stereo headphones (not supplied) into the metal detector and operate without trouble.
- **Ellipse Waterproof Search Coil-** Allows for you to search in shallow waters. The ellipse coil covers more surface area and has more advantages than a normal coil.
- **Adjustable Stem-** Lets you adjust the detector's length for comfortable use.
- **Arm Support-** Allows you to carry and operate your detector comfortably.
- **Power-** Your metal detector requires two (2) 9-volt alkaline batteries (not included) to operate. The built-in insulating circuit makes it so you avoid the wrong battery connection, in addition to prolonging the battery life.

PREPARATION

ASSEMBLING THE DETECTOR

Assembling your detector is easy and requires no special tools. Just follow these steps:

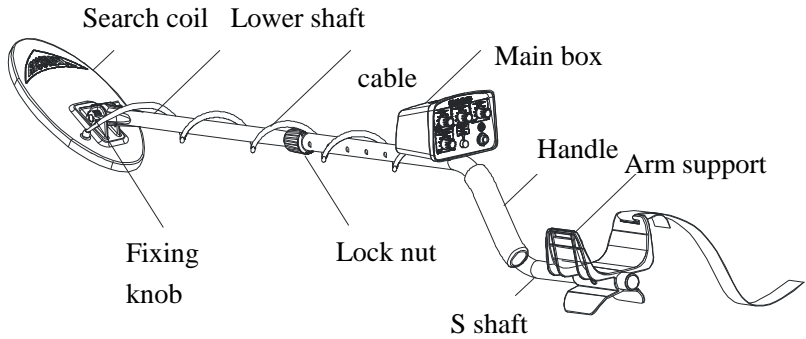

1. Loosen the fixing screws and take off the main box (operating console).

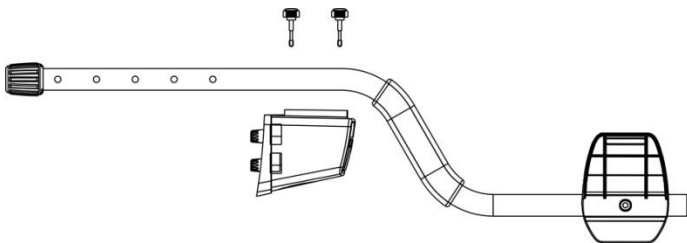

2. Fix the main box on the S shaft and tighten the screws properly (shown as below).

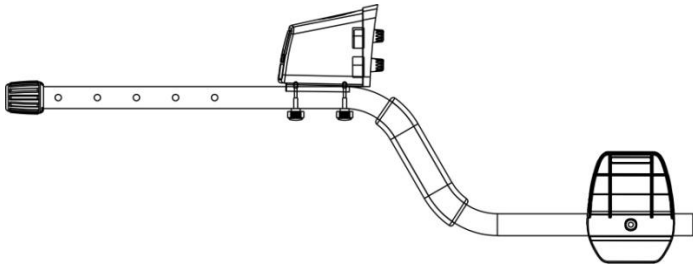

3. Loosen the lock nut counter-clockwise on the S shaft. Insert the lower shaft into the S shaft and tighten the lock nut.
4. Align the holes on the search coil bracket with the lower shaft. Push the connector through the holes, then replace and tighten the fixing knobs.
5. Wind the search coil cable around the shaft and insert the plug into the relevant jack.

Caution:

- The search coil's plug fits into the jack in only one-way. Do not force the plug into the jack because it can be damaged.
 - Don't pull the cable if you want to pull out the plug from the jack.
6. Rotate the lock nut on the shaft clockwise to loosen it.
 7. Stand and stretch your arm, holding the metal detector to make the search coil is above the ground approximately 1 to 5 cm. Rotate the lock nut on the shaft counterclockwise to re-tighten it.

Caution: Do not over tighten the lock nut.

INSTALLING THE BATTERIES

1. Check the power switch on the front panel of the main box to make sure it is in the "OFF" position.
2. Slide the battery cover on the left off in the direction the arrows point.
3. Place a 9V battery into the battery compartment matching the polarity symbols

- (+ and -) marked on the inside of the compartment, then reinstall the left battery cover.
- Slide the battery cover on the right off in the direction the arrows point.
 - Place a 9V battery into the battery compartment matching the polarity symbols (+ and -) marked on the inside, then reinstall the right battery cover.

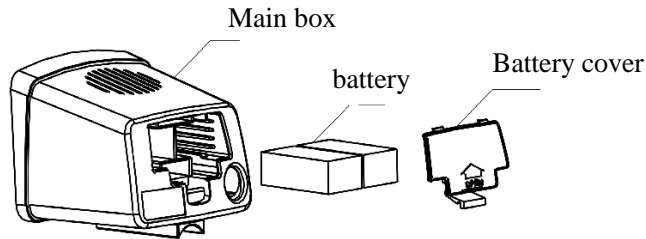

Caution:

- If you don't plan on using the metal detector for a week or more, remove the batteries. The batteries can leak chemicals that can destroy the electronic components of the metal detector.

Warning:

- Dispose of the old batteries promptly and properly. Never bury or burn any batteries.

USING HEADPHONES

1. Insert the stereo headphones into the 6.3mm plug (PHONE jack). At this time the external speaker will be disconnected and muted.
2. Rotate the volume control to the minimum position. After putting on the headphones, set the volume to desired level.

Listening Safely

- To protect your hearing, set the volume to the lowest setting before you begin listening, then adjust the volume to a comfortable level.
- Do not listen at the maximum (highest) volume level. Listening for an extended amount of time at the highest volume can lead to permanent

hearing loss.

- Do not wear your headphones while operating your metal detector near high-traffic areas. Pay attention to traffic safety.

A QUICK LOOK AT THE DETECTOR

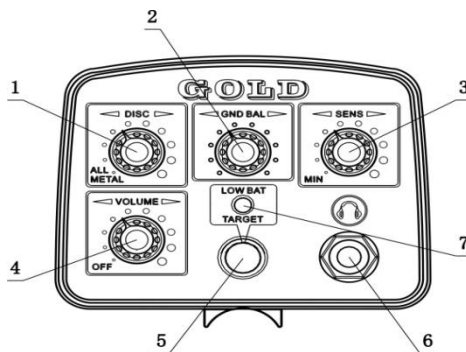

1. MODE SWITCH

- DISC-The mode DISC facilitates searching for and discriminating the target type based on the long or short tone for different metal targets.
- ALL METAL- This mode is used to search for all kinds of metal objects.

2. GND BAL- This is used to offset the effects of any minerals present in the soil and to balance the effects of saltwater.

3. SENS- Turn the dial control counter-clockwise all the way to get to the lowest sensitivity. As you slowly turn the SENS dial clockwise, the sensitivity will gradually increase. In general, you can set the SENS to the highest position, however in mineralized areas, or in areas with electrical interference, it is more effective to lower the SENS dial.

4. VOLUME- This dial is used to adjust the volume level. To decrease the volume (make lower) turn the dial counter-clockwise. To increase the volume

(make louder) turn the dial clockwise. The volume dial is also used as the power switch. Turn the dial completely counter-clockwise to power off the metal detector. To turn your metal detector on, rotate the dial clockwise away from the OFF position.

5. TARGET- This is used to pinpoint the target. Press the button to lower the sensitivity level and locate the target more accurately.
6. PHONE- Insert the stereo headphones' 3.5mm plug into the PHONE jack. At this time the external speaker will disconnected and muted.
7. LED- When the target is found, the green LED lights will come on. When red LED lights come on, this indicates that the battery is low. When the red LED lights are on, you have to replace the battery at this time.

OPERATION

Your TC-5000 has three operation modes: DISC, ALL METAL and TARGET. The DISC and ALL METAL modes are motion modes. You have to move the search coil to locate a target. While the TARGET mode is a non-motion mode.

When searching, the standard is to set the operation mode to ALL METAL and the SENS to less than 10. Sweep your search coil in a s-motion as detailed in the picture below. You want to move the search coil from right to left in an arced line. To avoid missing a target, it is best to keep the search coil approximately 1 – 5cm from the ground (keep the search coil closer to the ground for smaller targets) and maintain about a 10 – 15cm distance between two neighboring arcs.

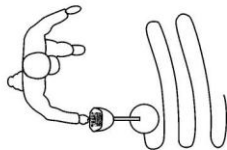

If there is a high-pitched tone sound during the sweeping motion of the search coils, it indicates that there is a metal target in the sound area. In this case, you

can use the TARGET mode to pinpoint the target. Then use DISC or TONE modes to determine whether the target is worth digging out.

The followings are the four operation modes in detail.

1. **ALL METAL-** Is the general searching mode. In this mode, the metal detector will respond with a high-pitch tone to all metal objects. However in this mode, the metal detector cannot discriminate between metal types. In this mode, you can adjust the GND BAL to minimize the interference from the soil's mineralization.
2. **DISC-** In this operating mode, the metal detector discriminates the metal type with different tones (short, long or silence). Set the DISC mode dial to "0". Slowly turn the control dial clockwise to a higher setting to reject objects you do not want. At different DISC positions, the metal detector can reject different undesired objects.

When DISC is set to "0", the metal detector will respond to any metal object with a long tone. As the control dial is rotated clockwise, the metal detector will sound a short tone, or even be silent to ferrous metal objects. This means the ferrous metal is rejected. When you further rotate the control dial clockwise, nickel, zinc, and copper will be rejected. When the control dial is set to "10", most metal objects will be rejected, except for silver. When set to "10", the metal detector will respond with a higher-pitched tone to silver.

3. **TARGET-** When you locate a metal object in the ALL METAL mode, you can press TARGET to pinpoint the object. Hold the search coil approximately 50cm or more away from the ground, then press and hold down the TARGET button. Sweep the search coil over the sound area and release the button when you hear a high-pitched tone. After about 1-2 seconds, hold down the red TARGET button again, the high-pitched tone will disappear. Hold the search coil closer to the ground; this will sound the high-pitched tone again. Repeat the above steps until you find the target. Once you have found the target, set the operating

mode to DISC to determine which kind of metal the target is.

4. Notes:

- (1) If there is interference from similar metal detectors in the area you are searching, you can either lower the sensitivity level on the main box or change the location of the area you are currently searching.
- (2) If there is interference from other instruments, electrical cables, TV or radio in the area you are searching, you can either lower the sensitivity level on the main box or change the location of the area you are currently searching.
- (3) When searching in highly mineralized areas, the metal detector will sound even if there is no metal. In this case, you can lower the sensitivity level and set discrimination to a higher position. You can also increase the height between the search coil and the ground until the false signal disappears. To accurately set the "DISC" mode, you may have to put a metal sample in the highly mineralized soil or wet sand for testing before setting it.
- (4) When searching in trash areas, it is more effective to set the "DISC" to the "5" position, so the metal detector can reject most of the invaluable metals, such as nails and small trashy iron.
- (5) Move away from all metal digging tools when searching.
- (6) In "TARGET" mode, the metal detector can discover any type of metal. So it is very likely to receive interference when you search for a small target near a large metal. In this case, you can remove the large metal or abandon this searching area.
- (7) The sensitivity level is generally in contradiction with that of the discrimination. The higher the sensitivity level is, the worse discrimination will be. However you can lower the sensitivity to achieve better discrimination.
- (8) To pinpoint the target, you can also move the search coil horizontally and vertically to make a cross at the sound point. The center of the cross is the location of the target.

CARE AND MAINTENANCE

Your metal detector is an example of superior design and craftsmanship. The following care instructions will help you maintain your metal detector so you can enjoy it for years.



Handle the metal detector gently and carefully. Dropping it can damage the circuit board and in some cases cause the metal detector to work improperly.



Use the metal detector only in normal temperature environments. Extreme temperatures can shorten the life of electronic devices, as well as cause damage to the plastic component that make up the case of the metal detector.



Keep the detector away from dust and dirt, which can cause premature wear of the parts.



Wipe the detector with a damp, clean cloth occasionally to keep it looking new. Do not use harsh chemicals, cleaning solvents, or strong detergents to clean your metal detector.